

# NOW LEASING



## Robinson Medical Center

22,122 SF | FULL BUILDING AVAILABLE

**133 CHURCH HILL ROAD** ROBINSON TWP, PA 15136

**OXFORD**  
www.oxfordrealtyservices.com

# PROPERTY DESCRIPTION

## BUILDING FEATURES

Opportunity to Lease the Full Building

Signage Available

22,000 SF Over Two Stories

Suite 1A - 7,203 SF  
Suite 1B - 3,733 SF  
Suite 2A - 7,273 SF  
Suite 2B - 3,821 SF

Updated / Modern 2nd Generation Medical Space

Full ADA Accessibility

Move-in Ready Medical Suites

Location Provides Great Visibility & Easy Access

Easy and Flexible access from both Parkway West (I-376) and I-79 (Crafton Interchange)

Prior Uses:  
-Primary Care  
-Orthopaedics  
-Imaging/MRI  
-OB/GYN



## DEMOGRAPHICS

	1-MILE	3-MILES
Population	4,159	23,751
Average HH Income	\$108,022	\$117,687
Daytime Employees	12,312	33,140



ROBINSON MEDICAL CENTER

# FLOOR PLANS

## FIRST FLOOR

Suite 1A - 7,203 RSF

- Reception / Check-In Area
- Private Offices / Exam Rooms
- Existing MRI / CT Infrastructure

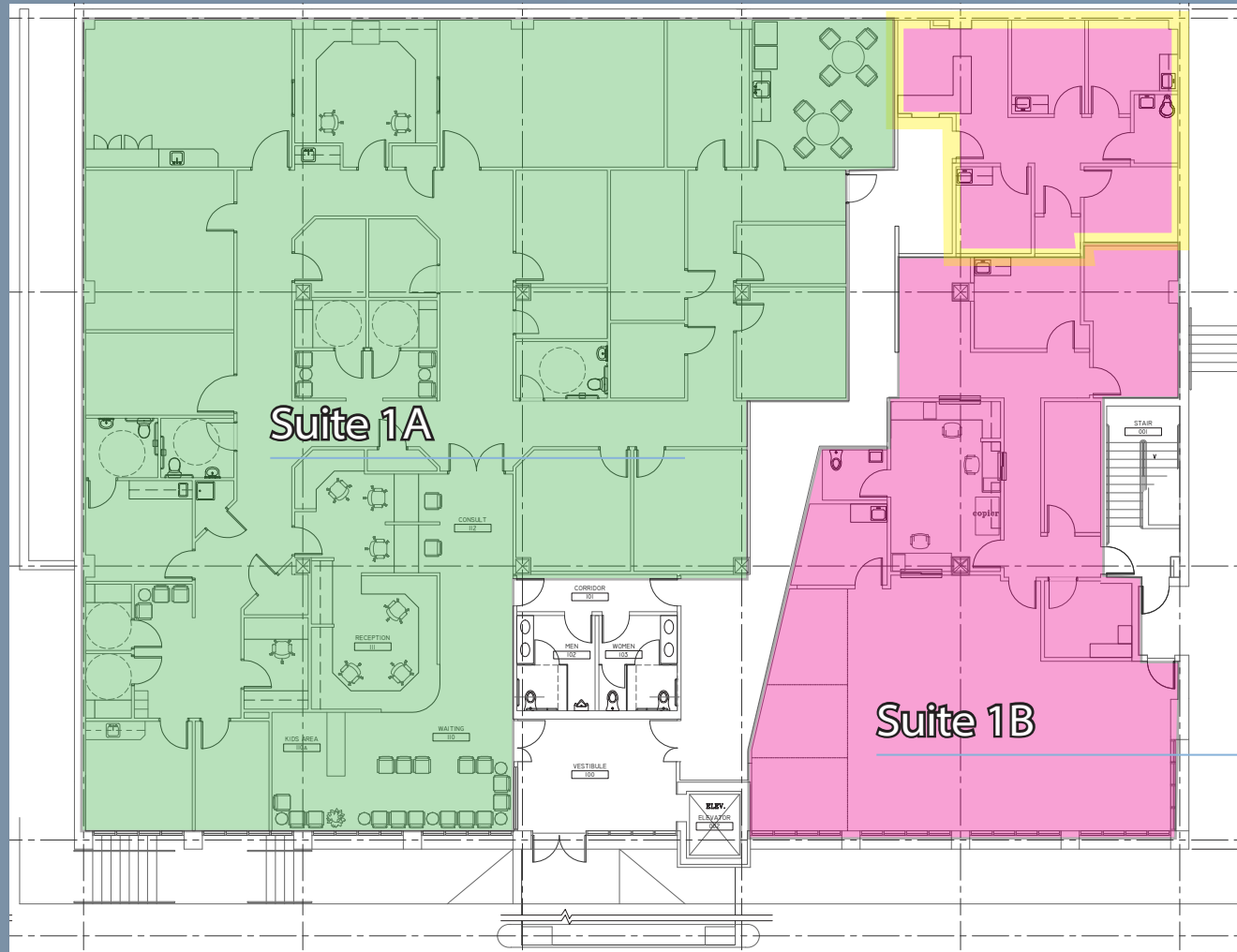

Suite 1B - 3,733 RSF

- Reception / Check-In Area
- Private Offices / Exam Rooms
- Complete PT / Rehab Gym
- Delineated space shown ideal for rotating specialties with dedicated check in and waiting area

# INTERIOR PHOTOS

## FIRST FLOOR

Waiting Room (1A)



Check-In Area (1A)



Existing CT Room (1A)



Open PT Area (1B)



Check-In Area (1B)



Private Office (1B)



ROBINSON MEDICAL CENTER

# FLOOR PLANS

## SECOND FLOOR

Suite 2A - 7,273 RSF

- Reception / Check-In Area
- 5 Private Offices
- 16 Exam Rooms
- 3 Nurse Stations
- Full Lab / Blood Draw Suite

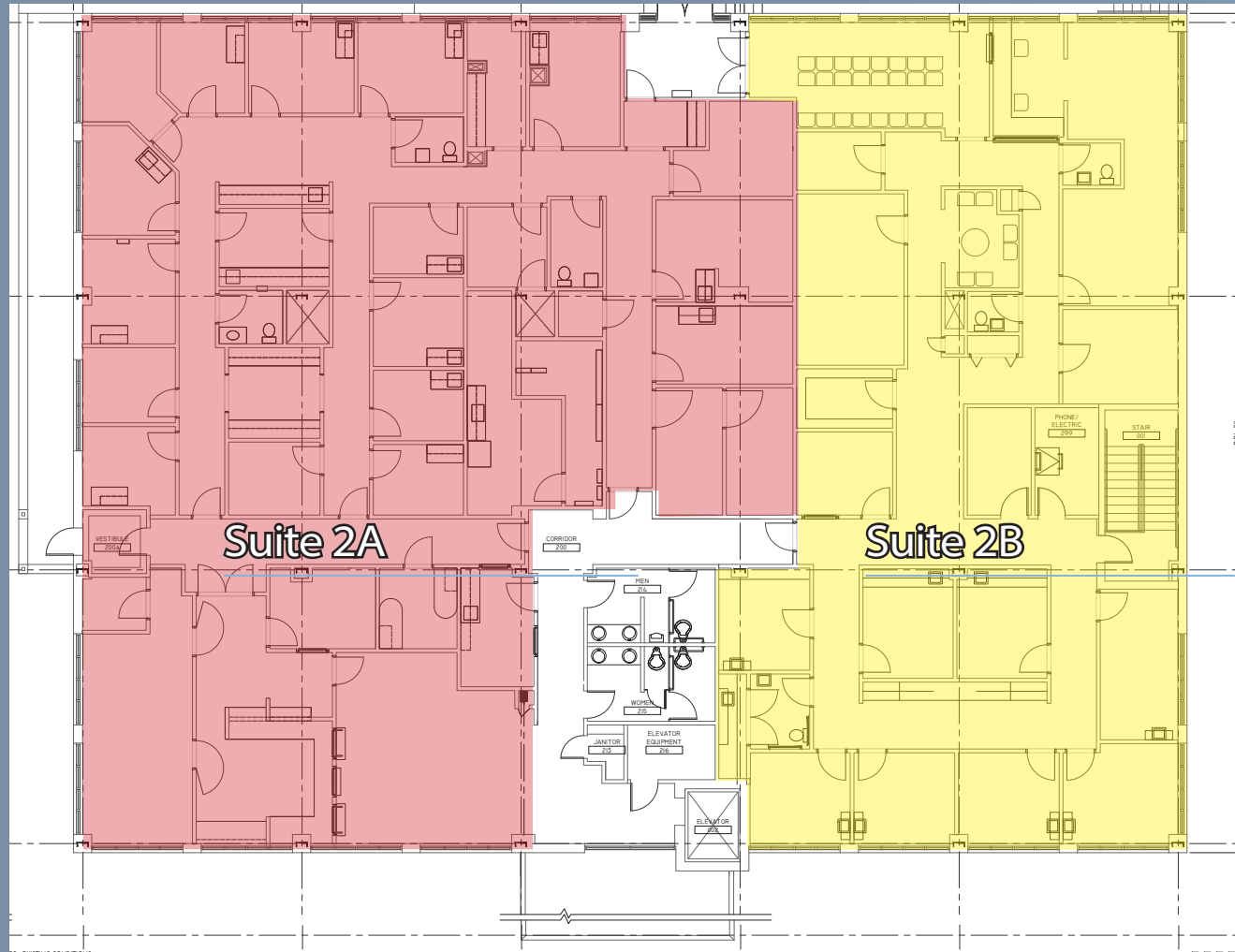

Suite 2B - 3,821 RSF

- Reception / Check-In Area
- 3 Private Offices
- 8 Exam Rooms
- Complete X-Ray / Imaging Suite

# INTERIOR PHOTOS

## SECOND FLOOR

Waiting Room (2A)



Nurses Station (2A)



Typical Exam Room (2A)



Check-In / Waiting Room (2B)



Typical Exam Room (2B)



X-Ray Exam Area (2B)



ROBINSON MEDICAL CENTER

# PROPERTY LOCATION



ROBINSON MEDICAL CENTER

For more information please contact:

**Andrew Martz**

Associate

412.261.0200, ext 3486

amartz@oxfordrealtyservices.com

**Joseph F. Tosi, SIOR**

Executive Vice President

412.261.0200, ext 3471

jtosi@oxfordrealtyservices.com

**Oxford Realty Services, Inc.**

2545 Railroad Street

Pittsburgh, PA 15222

www.oxfordrealtyservices.com



# Robinson Medical Center

**133 CHURCH HILL ROAD** ROBINSON TWP, PA 15136

**OXFORD**  
www.oxfordrealtyservices.com