

3 Crossings Project Overview

3 Crossings, located at the former Pitt Ohio Terminal facility in the Strip District, is a large-scale, multi-use residential, office, and retail development complex.

3 Crossings encompasses several city blocks featuring a 300 unit residential community ("The Yards"), 375,000 RSF of Class A office space, 10,000 SF of retail space and 1,200 parking spaces.

The project embraces the industrial architectural design qualities of the Strip District and other residential and office conversions in the area.



For more information please contact:

Arthur J. DiDonato, Jr.
Senior Vice President, Retail Brokerage
Oxford Realty Services, Inc.
412.261.0200, ext 3436
adidonato@oxfordrealtyservices.com

OXFORD
REALTY SERVICES, INC.

2545 Railroad Street - Suite 300
Pittsburgh, PA 15222
www.oxfordrealtyservices.com

Although all information furnished regarding property for sale, rental or financing is from sources deemed reliable, such information has not been verified, and no express representation is made nor is any to be implied as to the accuracy thereof, and it is submitted subject to errors, omissions, change of price, rental or other conditions, prior sale, lease or financing, or withdrawal without notice. Rental terms and all dimensions are approximate and specifications are subject to change without notice. Oxford Realty Services, Inc., an independent real estate services company.

OXFORD

FOR LEASE

REALTY SERVICES, INC.

Real Estate Brokerage Services

Office | Industrial | Retail | Investing | Consulting

THE Stacks at 3 Crossings

2865 & 2875 Railroad Street, Strip District, Pittsburgh, PA 15222



Building Highlights

- 3,331 SF
- 6,611 SF - Plus 1,258 SF Outdoor Private Patio
- 7,040 SF
- The Stacks features an Industrial Plaza - A central, outdoor plaza between buildings
- Stacks Fitness - a full service fitness facility operated in partnership with Mecka Fitness

Property Highlights

- 3 Crossings is a large-scale, multi-use residential, office, and retail development complex that reconnects the Strip District neighborhood to the natural amenities of a revitalized riverfront and Pittsburgh's Three Rivers
- Prime location at the former Pitt Ohio Terminal facility in the Strip District - a fast growing part of the Strip District which features new office buildings, retail development, and luxury condos
- Daytime population within 4 blocks - 2,051

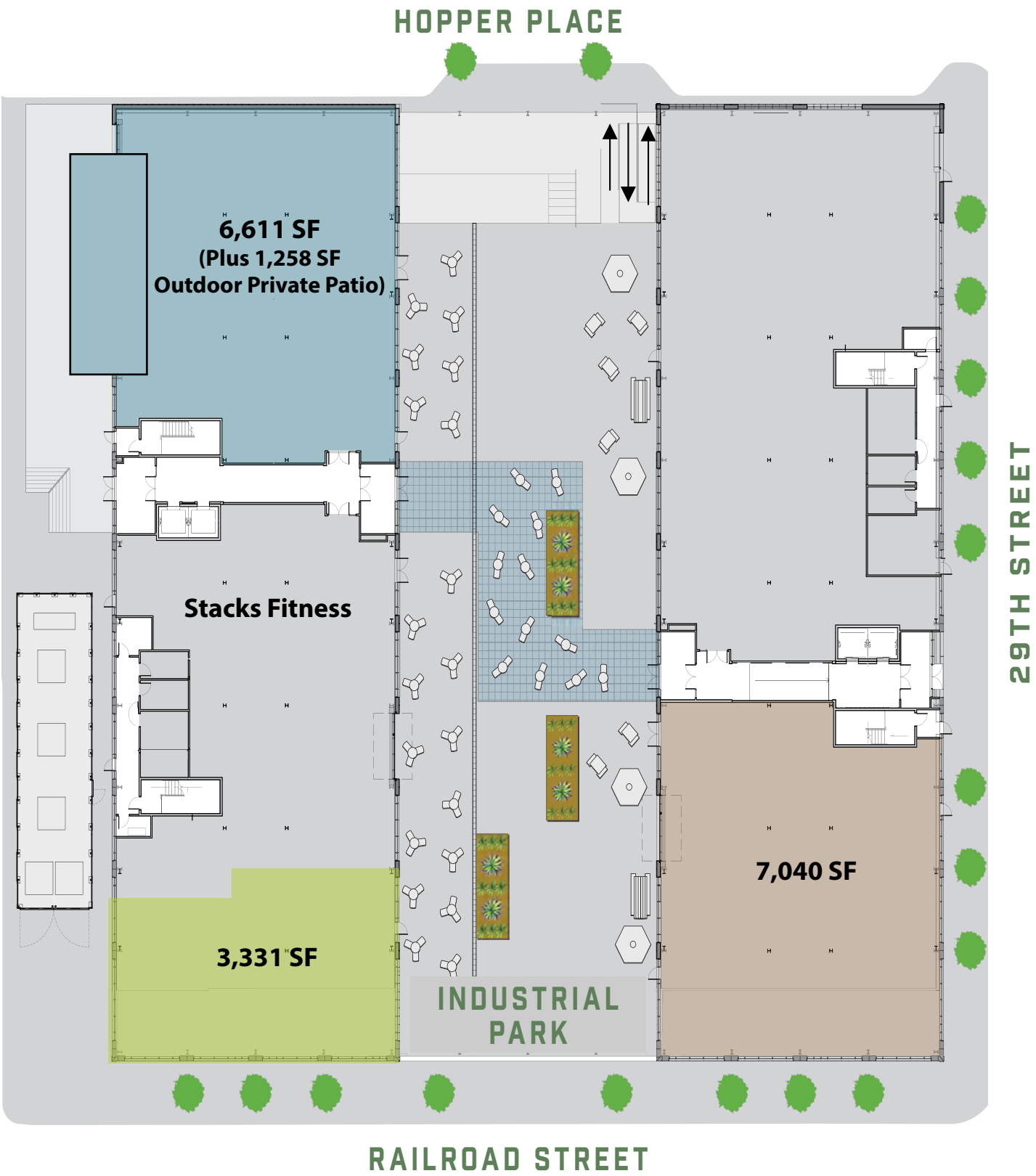

By The Numbers

Average Household Income	Median Home Values	Average Gross Rent	Bachelor's Degree or Higher	Estimated Daytime Population
\$127,711	\$425,000	\$1,882	84.3%	42,049

Source: U.S. Census Bureau, Census 2010 Summary File 1. Esri forecasts for 2019

Recent/Planned Developments	Office Space 2.2M SF	Residential Units 1,200	Retail Space 282,900SF	Parking 2,385 spaces	Hotel 283 keys