



For more information please contact:

Arthur J. DiDonato, Jr.
Senior Vice President, Retail Brokerage
Oxford Realty Services, Inc.
412.261.0200, ext 3436
adidonato@oxfordrealtyservices.com

Alec M. Parchinski
Associate
Oxford Realty Services, Inc.
412.261.0200, ext 3485
aparchinski@oxfordrealtyservices.com

OXFORD

REALTY SERVICES, INC.

2545 Railroad Street
Pittsburgh, PA 15222
www.oxfordrealtyservices.com

Although all information furnished regarding property for sale, rental or financing is from sources deemed reliable, such information has not been verified, and no express representation is made nor is any to be implied as to the accuracy thereof, and it is submitted subject to errors, omissions, change of price, rental or other conditions, prior sale, lease or financing, or withdrawal without notice. Rental terms and all dimensions are approximate and specifications are subject to change without notice. Oxford Realty Services, Inc., an independent real estate services company.

OXFORD

REALTY SERVICES, INC.

FOR LEASE

Real Estate Brokerage Services

Office | Industrial | Retail | Investing | Consulting

Village Square Mall

4000 Oxford Drive, Bethel Park, PA 15102



Available Space

- 71,506 SF
- 8,500 SF (Former TGI Friday's)

Property Highlights

- Prime location at the Route 19/Fort Couch Road intersection across from South Hills Village, in the heart of the Bethel Park regional trade area
- Anchor tenants include Kohl's, Home Depot, Michael's, Office Depot, and Bob's Discount Furniture
- Outparcels include Wine & Spirits, Olive Garden & Huntington Bank

AVERAGE DAILY TRAFFIC

| | |
|-----------------|--------|
| Route 19 | 34,132 |
| Fort Couch Road | 23,831 |

DEMOGRAPHICS

| | 3-MILES | 5-MILES |
|----------------|-----------|-----------|
| Population | 92,922 | 239,474 |
| Avg. HH Income | \$125,092 | \$107,616 |

Lease Plan

Lower Level Plan

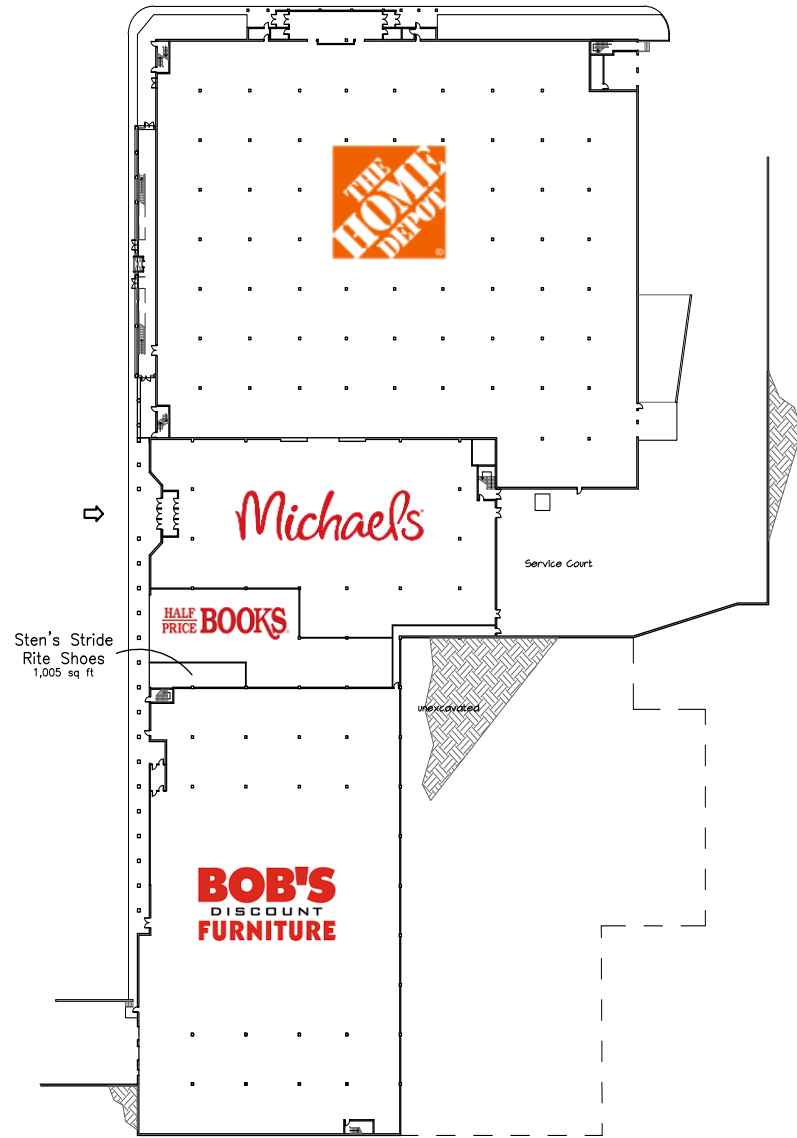

Upper Level Plan

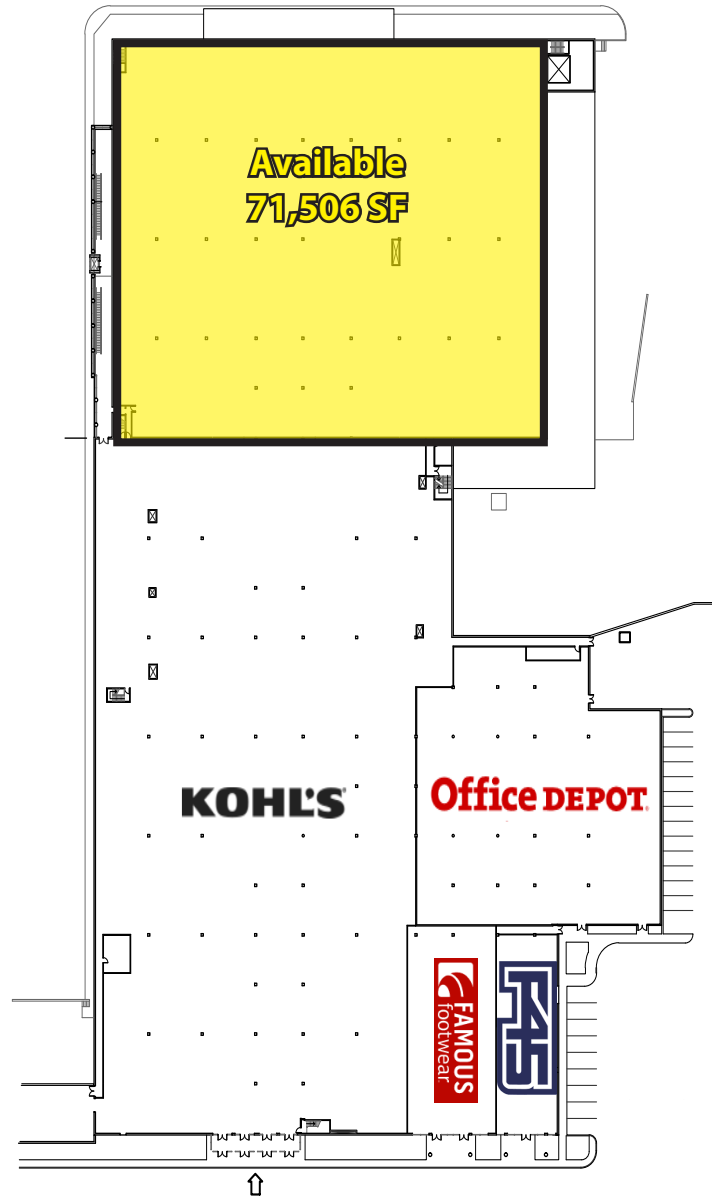

Tenant List (Lower Level)

| | |
|--------------------------|-----------|
| The Home Depot | 82,337 SF |
| Michael's | 23,693 SF |
| Half Price Books | 6,945 SF |
| Stride Rite Shoes | 1,005 SF |
| Bob's Discount Furniture | 46,620 SF |

Tenant List (Upper Level)

| | |
|------------------|------------------|
| Available | 71,506 SF |
| Kohl's | 91,348 SF |
| Office Depot | 25,000 SF |
| Famous Footwear | 7,560 SF |
| F45 Training | 5,040 SF |

Site Plan

