



# OXFORD

REALTY SERVICES, INC.

For more information please contact:

**Andrew Martz**

Associate

Oxford Realty Services, Inc.

412.261.0200, ext 3486

amartz@oxfordrealtyservices.com

2545 Railroad Street

Pittsburgh, PA 15222

www.oxfordrealtyservices.com

Although all information furnished regarding property for sale, rental or financing is from sources deemed reliable, such information has not been verified, and no express representation is made nor is any to be implied as to the accuracy thereof, and it is submitted subject to errors, omissions, change of price, rental or other conditions, prior sale, lease or financing, or withdrawal without notice. Rental terms and all dimensions are approximate and specifications are subject to change without notice. Oxford Realty Services, Inc., an independent real estate services company.

# OXFORD

REALTY SERVICES, INC.

# FOR SUBLEASE

Real Estate Brokerage Services

Office | Industrial | Retail | Investing | Consulting

## K&L Gates Center

210 Sixth Avenue, Pittsburgh, PA 15222



### Building **Size**

637,231 RSF

### Available **Premises**

18,237 RSF - 32<sup>nd</sup> Floor

18,902 RSF - 33<sup>rd</sup> Floor

### Sublease **Term**

Through June 30, 2027

### Property **Highlights**

- Located in the heart of Downtown with excellent views
- On-site indoor parking
- Immediate occupancy
- Furniture available for plug-&-play solution
- Modern space with a mix of open areas and private offices
- On-site property management and 24-hour security
- Various restaurants and amenities within walking distance



32<sup>nd</sup> Floor

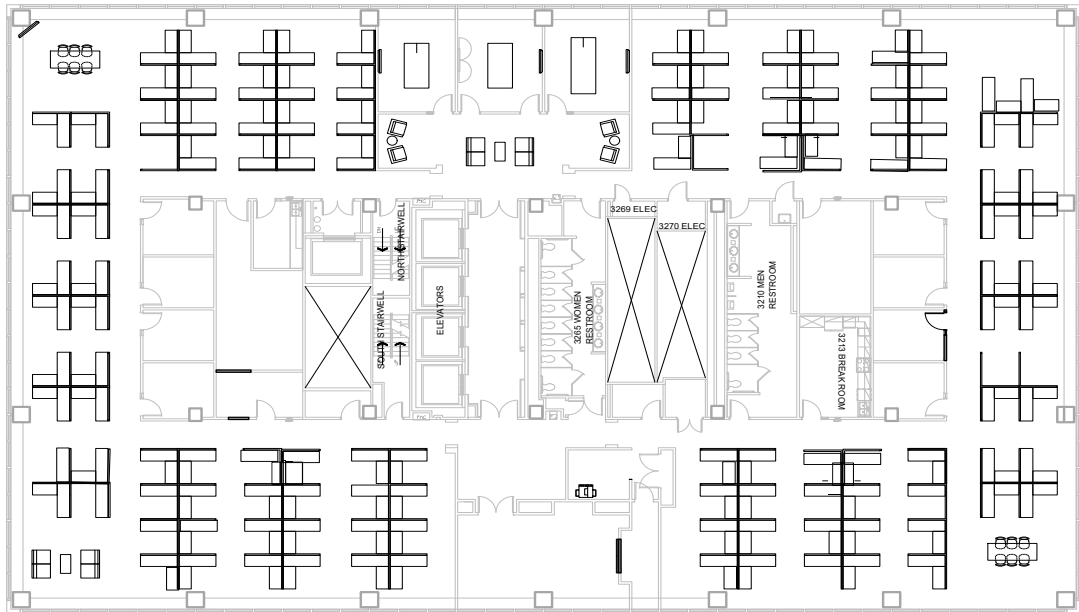

33<sup>rd</sup> Floor

