



OXFORD

REALTY SERVICES, INC.

FOR SUBLEASE

Real Estate Brokerage Services

Office | Industrial | Retail | Investing | Consulting

K&L Gates Center

210 Sixth Avenue, Pittsburgh, PA 15222



Building Size

637,231 RSF

Available Premises

18,237 RSF - 32nd Floor
18,902 RSF - 33rd Floor
12,379 RSF - 34th Floor
+ 5,911 RSF - 34th Floor - Storage

Sublease Term

Through June 30, 2027

Property Highlights

- Located in the heart of Downtown with excellent views
- On-site indoor parking
- Immediate occupancy
- Furniture available for plug-&-play solution
- Modern space with a mix of open areas and private offices
- On-site property management and 24-hour security
- Various restaurants and amenities within walking distance



For more information please contact:

Jeffrey A. Deitrick, SIOR
Executive Vice President

Oxford Realty Services, Inc.
412.261.0200, ext 3473
jdeitrick@oxfordrealtyservices.com

Andrew Martz
Associate

Oxford Realty Services, Inc.
412.261.0200, ext 3486
amartz@oxfordrealtyservices.com

OXFORD

REALTY SERVICES, INC.

2545 Railroad Street - Suite 300
Pittsburgh, PA 15222
www.oxfordrealtyservices.com

Although all information furnished regarding property for sale, rental or financing is from sources deemed reliable, such information has not been verified, and no express representation is made nor is any to be implied as to the accuracy thereof, and it is submitted subject to errors, omissions, change of price, rental or other conditions, prior sale, lease or financing, or withdrawal without notice. Rental terms and all dimensions are approximate and specifications are subject to change without notice. Oxford Realty Services, Inc., an independent real estate services company.

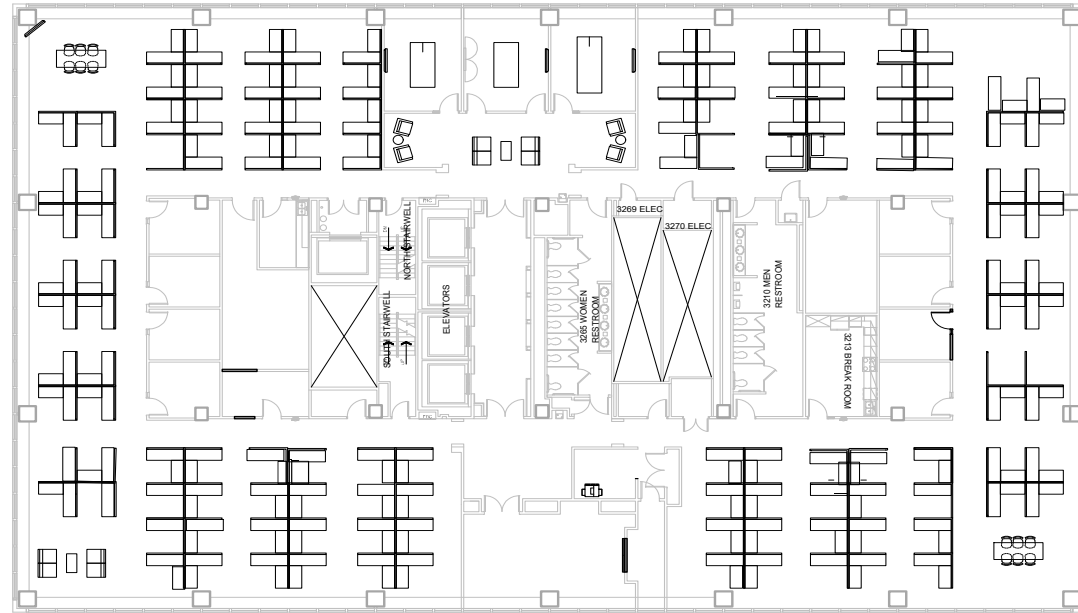

32nd Floor



33rd Floor

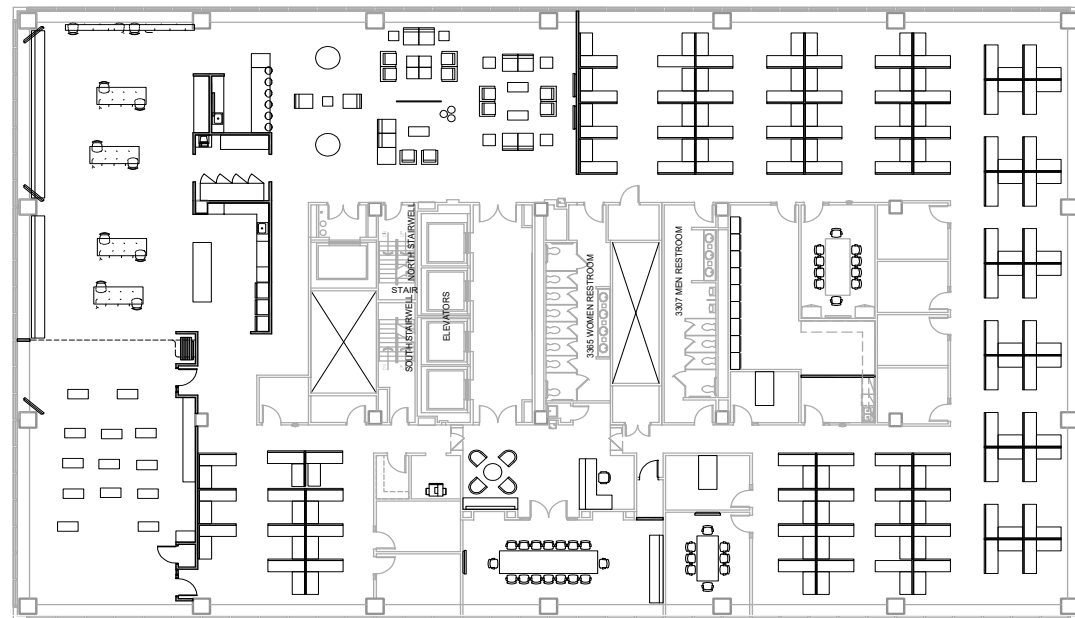

34th Floor

