

495 Lincoln Avenue

Bellevue, PA 15202



Available Premises

Building (Parcel 160-L-203)

- Entire 8,248 SF Building
 - 1st Floor 4,124 SF
 - 2nd Floor 4,124 SF
- Full basement for storage or back of the house uses

Surface Parking and Drive-Thru ATM

(Parcel 160-L-200)

- 10,000 SF surface lot with two points of access
- 19 surface spaces (plus 3 adjacent to building)
- Drive-thru ATM structure

Property Highlights

- Located on a signalized corner in Bellevue's commercial district
 - Walkable community with a mix of residential and business uses
 - MU / Mixed Use Zoning (Bellevue Borough) – office, retail, medical or mixed-use opportunities
- First floor provides over 18' clear high with large windows providing significant daylight
- Value add opportunity to renovate or repurpose 2nd floor. Full basement for storage or back of the house uses
- Property includes surface lot with 22 off-street parking and an existing drive-thru ATM kiosk building
- Ability to lease the ATM drive-thru separately (Citizens Bank current lease expires in June 2025)

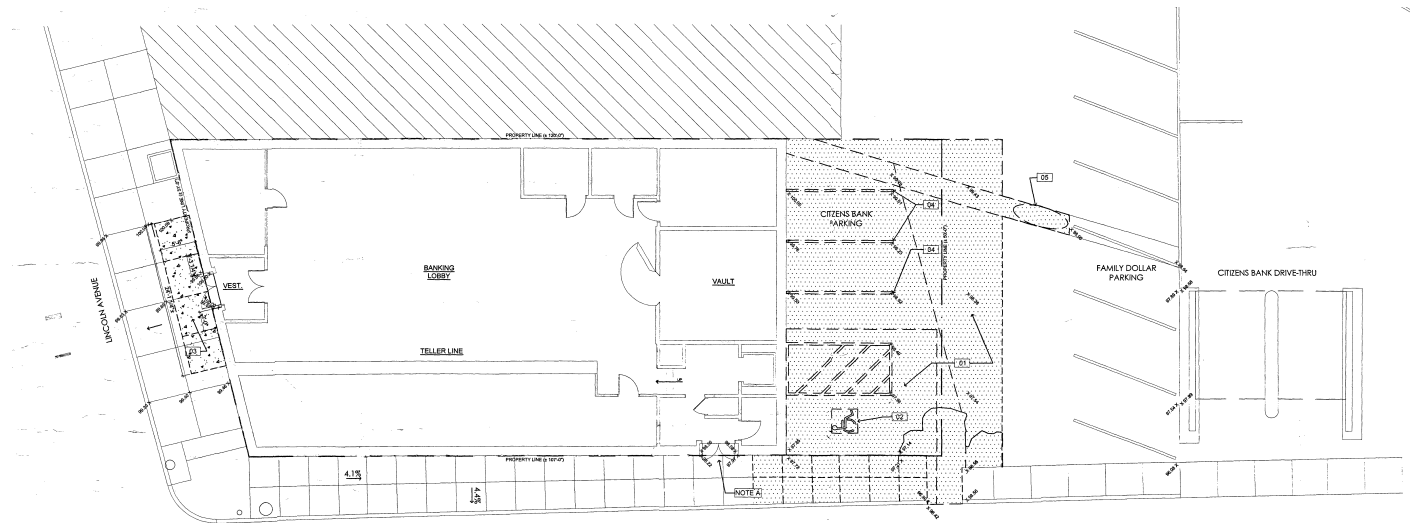

Site Size

Approximately 0.32 acres or 13,939 SF



AVERAGE DAILY TRAFFIC

13,631 Vehicles Daily – Lincoln Avenue

DEMOGRAPHICS

	1-MILE	3-MILES	5-MILES
Population	15,580	81,842	199,220
Avg. HH Income	\$68,862	\$73,167	\$85,316



For more information please contact:

Joe Tosi, SIOR
Executive Vice President

Oxford Realty Services, Inc.
412.261.0200, ext 3471
jtosi@oxfordrealtyservices.com

Andrew Martz
Associate

Oxford Realty Services, Inc.
412.261.0200, ext 3486
amartz@oxfordrealtyservices.com

OXFORD
REALTY SERVICES, INC.

2545 Railroad Street
Pittsburgh, PA 15222
www.oxfordrealtyservices.com

Although all information furnished regarding property for sale, rental or financing is from sources deemed reliable, such information has not been verified, and no express representation is made nor is any to be implied as to the accuracy thereof, and it is submitted subject to errors, omissions, change of price, rental or other conditions, prior sale, lease or financing, or withdrawal without notice. Rental terms and all dimensions are approximate and specifications are subject to change without notice. Oxford Realty Services, Inc., an independent real estate services company.