

Ross Towne Center

7219 McKnight Road, Pittsburgh, PA 15237



Available Premises

38,542 SF (former JoAnn Fabrics)

Property Highlights

- Average Daily Traffic on McKnight Road is 40,789
- Shares signalized access with Ross Park Mall
- Ideally located with great visibility along the heavily traveled McKnight Road corridor and across from the Super Regional Ross Park Mall main entrance
- Co-Tenant's include the new Going, Going, Gone by Dick's Sporting Goods, Ashley Home Store, Panda Express, Dollar Tree, Clearview Federal Credit Union, Affordable Care and Bank of America, along with Jared, Denny's, Wendy's, Aldi, Panera Bread, Plato's Closet, MedExpress, and Bob's Discount Furniture.

DEMOGRAPHICS

	3-MILES	5-MILES	10-MILES
Population	65,223	161,095	649,500
Avg. HH Income	\$109,533	\$102,890	\$99,696

38,542 SF

Former JoAnn Fabrics

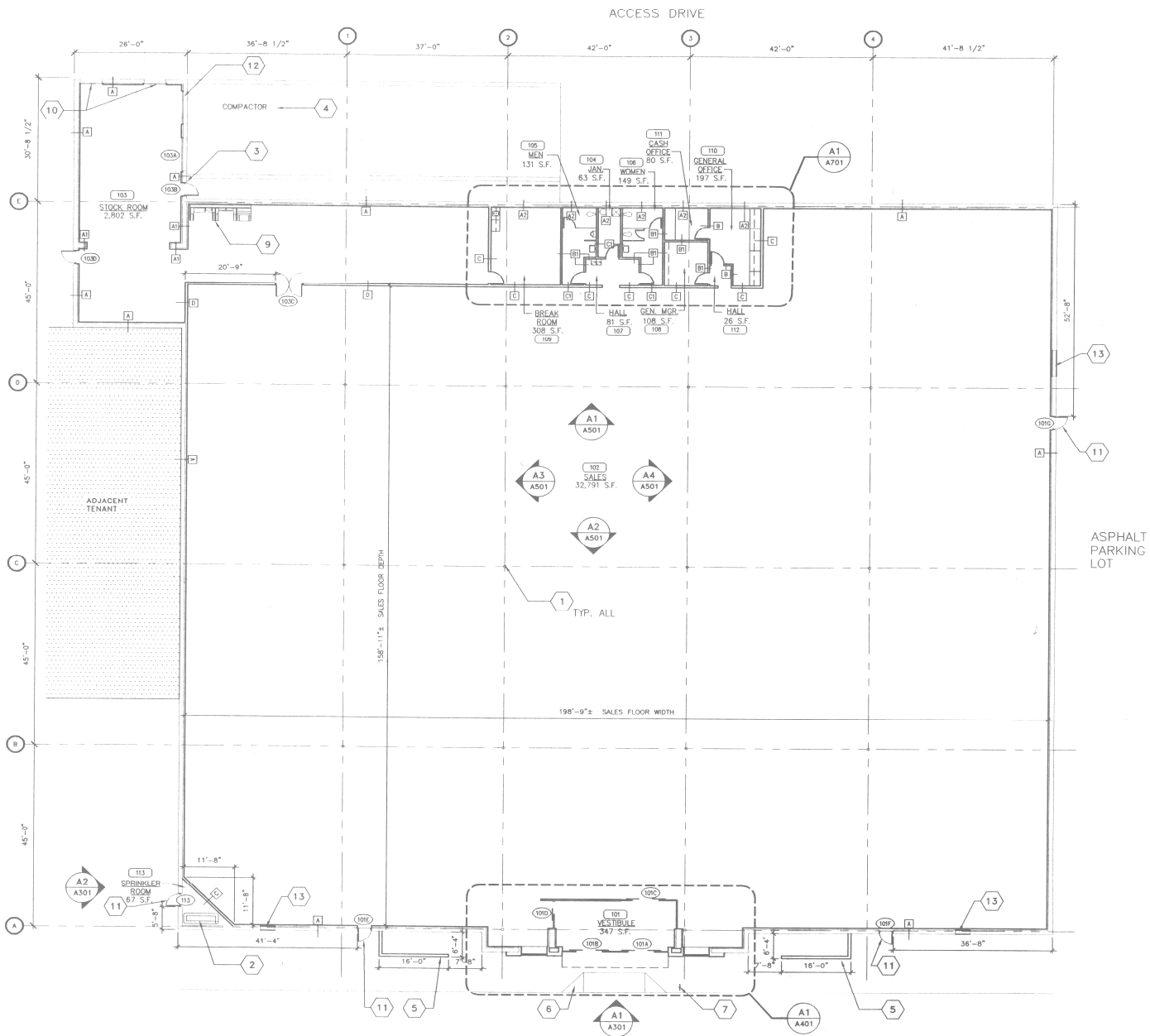

Site Plan



Tenants

Clearview FCU	2,707 SF
Plato's Closet	3,950 SF
Affordable Care	4,556 SF
MedExpress	5,000 SF
Dollar Tree	9,450 SF
Going, Going, Gone	32,104 SF SF
Available	38,542 SF
Bob's Discount Furniture	25,000 SF

For more information please contact:

Arthur J. DiDonato, Jr.
Senior Vice President, Retail Brokerage

Oxford Realty Services, Inc.
412.261.0200, ext 3436
adidonato@oxfordrealtyservices.com

Alec M. Parchinski
Associate

Oxford Realty Services, Inc.
412.261.0200, ext 3485
aparchinski@oxfordrealtyservices.com

OXFORD
REALTY SERVICES, INC.

2545 Railroad Street
Pittsburgh, PA 15222
www.oxfordrealtyservices.com

Although all information furnished regarding property for sale, rental or financing is from sources deemed reliable, such information has not been verified, and no express representation is made nor is any to be implied as to the accuracy thereof, and it is submitted subject to errors, omissions, change of price, rental or other conditions, prior sale, lease or financing, or withdrawal without notice. Rental terms and all dimensions are approximate and specifications are subject to change without notice. Oxford Realty Services, Inc., an independent real estate services company.