

# NOW LEASING



**2125 JANE STREET | PITTSBURGH, PA**

**OXFORD**  
REALTY SERVICES, INC.

# PROPERTY DESCRIPTION

## BUILDING SIZE

12,000 SF

## AVAILABLE PREMISES

4,000 SF

## PROPERTY HIGHLIGHTS

- Located in the heart of the South Side
- Two (2) automatic drive-in doors
  - (Jane Street) 16' wide x 16' high
  - (Rear) 20' wide x 16' high
- Vector security system in place
- Power - 3-Phase 480/240V, 400A
- Space 32' wide 118' deep
- 18' clear height

## LEASE RATE

\$10.00 - \$12.00/SF NNN



2125 JANE STREET

# FLOOR PLAN & INTERIOR PHOTOS

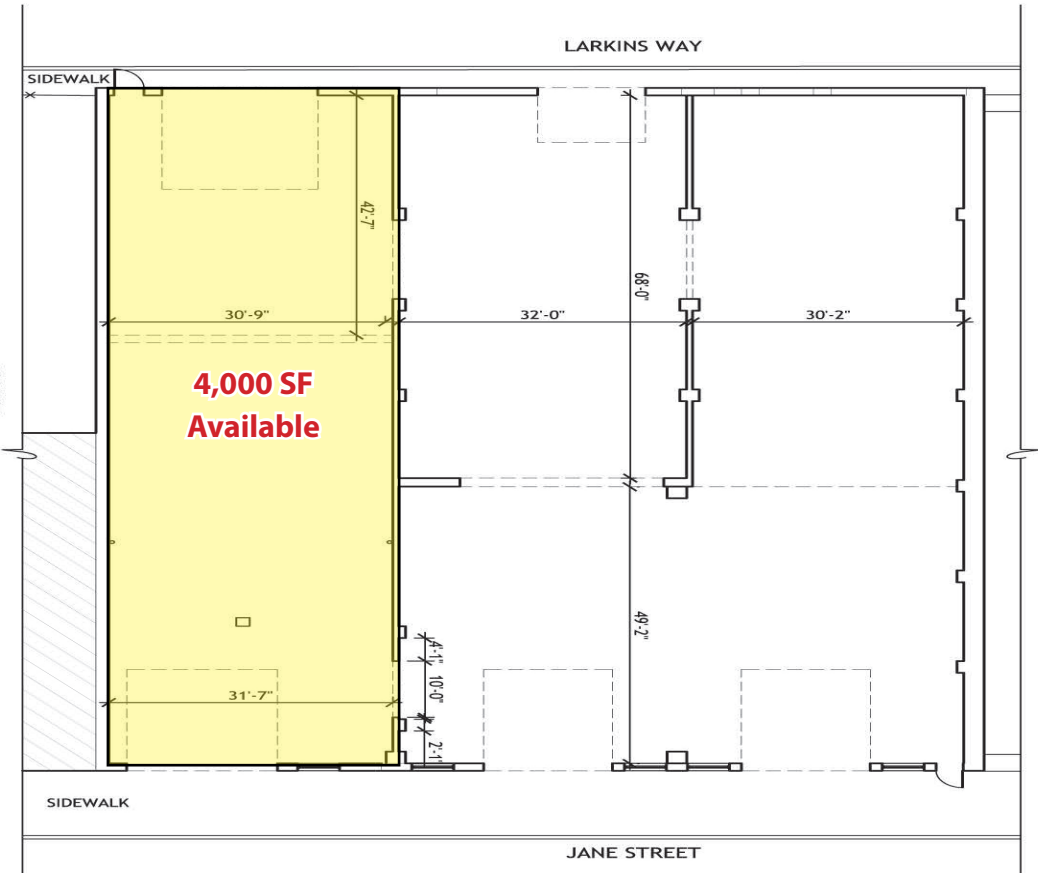

2125 JANE STREET

# PROPERTY LOCATION

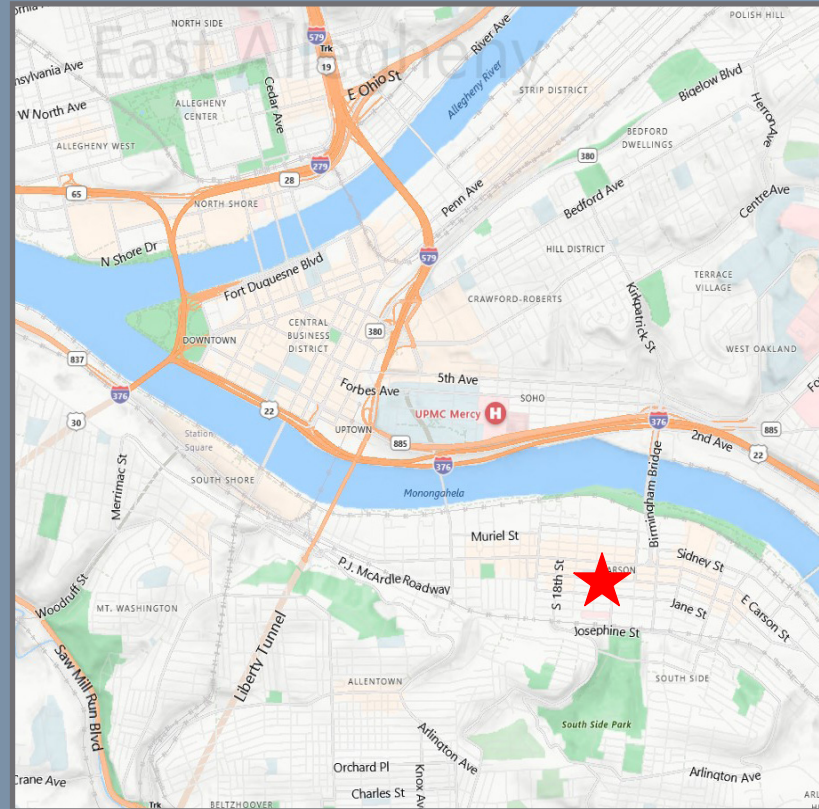

For more information please contact:

**Spencer Baker**  
Associate

412.261.0200, ext 3460  
sbaker@oxfordrealtyservices.com

**Joseph F. Tosi, SIOR**  
Executive Vice President

412.261.0200, ext 3471  
jtosi@oxfordrealtyservices.com

**Oxford Realty Services, Inc.**  
2865 Railroad Street, Suite 202  
Pittsburgh, PA 15222  
www.oxfordrealtyservices.com

2125 JANE STREET